

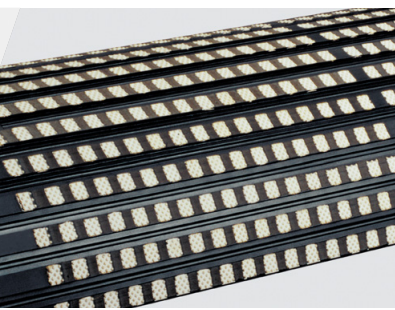

// ONE BRAND // ONE SOURCE // ONE SYSTEM

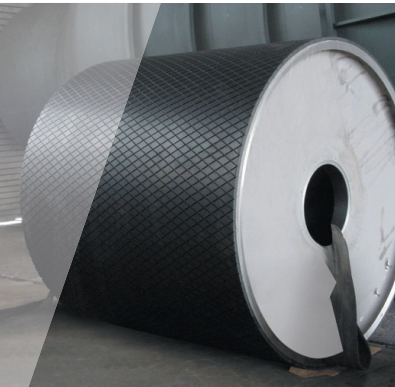
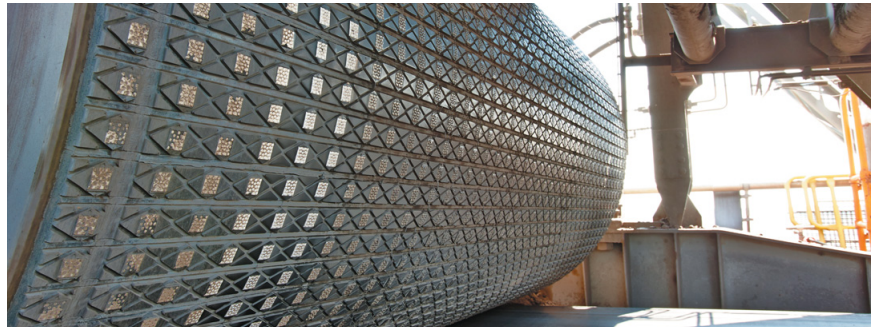

REMAGRIP & REMASLEEVE

Pulley Laggings and Belt Idler Sleeves

APPLICATION CHART

Technical data

Pulley Lagging Selection Guide:

	Pulley Lagging		FABRIC CONVEYOR BELT			STEELCORD CONVEYOR BELT		
			PIW Rating			PIW Rating		
	Driven	Non-Driven	< 440	440 - 800	> 800	< 700	700 - 1400	> 1400
REMAGRIP 50	X	X	5/16"					
REMAGRIP 60	X	X	5/16"	1/2"				
REMAGRIP 65	x	X	5/16"	1/2"		3/8"	1/2"	
PERFORMANCEgrip 70	X	X		3/8"	1/2"		1/2"	3/4"
PERFORMANCEgrip 70/CN - SL	X	X		1/2"	1/2"		1/2"	3/4"
REMA LINE 40		X	3/8"					
REMA LINE 50		X	3/8"					
REMA LINE 60		X	3/8"	1/2"	5/8"			
REMAGRIP 100/CN	X		1/2"					
REMAGRIP 100 HD/CN								
REMAGRIP 60 WHITE		X	5/16"					
REMAGRIP 200 WHITE	X	X	5/16"					
CK-X CERAMIC	X	x		5/8"	5/8"	5/8"	5/8"	5/8"
CP-X CERAMIC		X		5/8"	5/8"	5/8"	5/8"	5/8"

Note: The above chart is intended as a guide only and references standard in-stock products.

Coefficients of friction (Pulley - Belt):

Operating conditions	Coefficients of friction		
	Steel	REMAGRIP Rubber lagging	REMAGRIP C Ceramic lagging
Dry	0.35 to 0.40	0.40 to 0.45	0.75 to 0.85
Wet	0.10 to 0.15	0.33 to 0.38	0.50 to 0.80
Wet and muddy	0.05 to 0.10	0.22 to 0.30	0.45 to 0.55

Coefficient of friction according to the DIN 22101 standard. Friction body: Belt cover in standard quality.

REMASLEEVE VSB and KSB

REMASLEEVE special rubber sleeves for conveyor belt idlers

REMASLEEVE special rubber sleeves for conveyor belt idlers for all common diameters of idlers according to the DIN standard. Quick and easy mounting through pneumatic device.

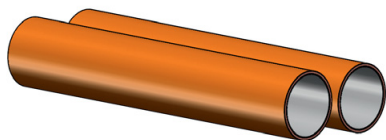

REMASLEEVE VSB-RE 40 ORANGE

Properties:

- Protection against caking, wear and corrosion



REMASLEEVE VSB-E 40

Properties:

- Protection against caking, wear and corrosion



REMASLEEVE KSB-E 60

Properties:

- Protection against corrosion and wear

Technical Data:

Property	REMASLEEVE VSB-RE 40 ORANGE/CN	REMASLEEVE VSB-E 40/CN	REMASLEEVE KSB-E 60/CN
Polymer	NR	NR/SBR	NR/BR/SBR
Density	1.05 g/cm ³ (62.43 lb/ft ³)	1.04 g/cm ³ (64.93 lb/ft ³)	1.13 g/cm ³ (70.54 lb/ft ³)
Hardness [Shore A]	44 Shore A	40 Shore A	58 Shore A
Color	Orange	Black	Black

REMAGRIP 50 and 60

For fabric conveyor belts in light to medium-duty operating conditions



REMAGRIP 50/CN



REMAGRIP 60/CN

Available special rubber grades: V, OIL, S, HR

Fields of application and product advantages:

- Grooved rubber lagging for drive pulleys
- Avoidance of material build-up with positive influence on belt tracking
- Reduced slippage between belt and pulley through increased coefficient of friction
- Elimination of moisture and dirt
- Protects pulleys from wear and corrosion
- Pulley lagging for low to medium-tension fabric belts

Technical Data:

Property	REMAGRIP 50/CN	REMAGRIP 60/CN	REMAGRIP 60 V/CN	REMAGRIP 60 OIL/CN	REMAGRIP 60 S/CN	REMAGRIP 60 HR/CN
Polymer	NR	BR/IR/SBR	CR	NBR	SBR/BR	IR/BR
Density [g/cm³] [lb/ft³]	1.08 (67.42)	1.12 (69.92)	1.40 (87.40)	1.20 (74.91)	1.24 (77.41)	1.12 (69.92)
Hardness [Shore A]	50 ± 5	63 ± 5	62 ± 5	65 ± 5	68 ± 5	62 ± 5
Abrasion [mm³]	130	120	130	125	125	60
Resilience [%]	73	47	27	25	40	53
Profile grooves [inches]	$\frac{11}{16} \times \frac{1}{4} \times \frac{1}{8}$	$\frac{11}{16} \times \frac{1}{4} \times \frac{1}{8}$	$\frac{11}{16} \times \frac{1}{4} \times \frac{1}{8}$	$\frac{11}{16} \times \frac{1}{4} \times \frac{1}{8}$	$\frac{11}{16} \times \frac{1}{4} \times \frac{1}{8}$	$\frac{11}{16} \times \frac{1}{4} \times \frac{1}{8}$
Color	orange	black	black	black	black	black
Flammability	—	—	self-extinguishing ¹⁾	—	flame resistant ²⁾	—
Electric Resistance	—	—	anti-static ^{1) 3)}	—	anti-static ³⁾	—
Approval for underground use	—	—	D (LOBA) ⁴⁾ PL (WUG) ⁵⁾ USA (MSHA) ⁶⁾ RUS (GOST) ⁷⁾	—	—	—
Operating temperature	- 22 °F to + 176 °F - 30 °C to + 80 °C	- 22 °F to + 176 °F - 30 °C to + 80 °C	- 22 °F to + 176 °F - 30 °C to + 80 °C	- 22 °F to + 176 °F - 30 °C to + 80 °C	- 22 °F to + 176 °F - 30 °C to + 80 °C	- 22 °F – + 194 °F to + 230 °F for a short time - 30 °C – + 90 °C to + 110 °C for a short time

¹⁾ Meets all safety requirements according to DIN 22100-7 (fire safety, hygiene, electrical)

²⁾ according to EN 20340

³⁾ also for ATEX-installations

⁴⁾ LOBA-No.: 18.43.21-89-33

⁵⁾ Polish approval: Dopuszczenie WUG Katowice-no. GM97/03

⁶⁾ USA: MSHA IC-205/1

⁷⁾ RUS: GOST PPC 00-17855

Special rubber grades

"V"	Self-Extinguishing
"S"	Flame-Resistant
"HR"	Heat Resistant
"OIL"	Oil-Resistant

REMAGRIP 65 and 70

For medium to heavy-duty operating conditions



REMAGRIP 65/CN

Available special rubber grades: V



REMAGRIP 70/CN

Available special rubber grades: V, S, HR



REMAGRIP 70/CN-SL

(strip lagging)

Fields of application and product advantages:

- Grooved rubber lagging for drive pulleys
- Avoidance of material build-up with positive influence on belt tracking
- Reduced slippage between belt and pulley through increased coefficient of friction
- Elimination of moisture and dirt
- Protects the pulleys from wear and corrosion
- Long belt conveyors (REMAGRIP 70)
- Large pulley diameters (REMAGRIP 70)
- For high-tension fabric belts and medium to high-tension steel-cord belts (REMAGRIP 70)

Further advantages REMAGRIP 70/CN-SL (strip lagging):

- Significantly improved elimination of water through additional horizontal grooves
- Preparation of the strips in the workshop, in the warehouse or on site
- Scrap reduced to a minimum
- Can be trimmed precisely with the REMA TIP TOP rubber cutting saw #32
- Easy application, even to pulleys in situ

Technical Data:

Property	REMAGRIP 65/CN	REMAGRIP 65 V/CN	REMAGRIP 70/CN	REMAGRIP 70 V/CN	REMAGRIP 70 S/CN	REMAGRIP 70 HR/CN	REMAGRIP 70/CN-SL
Polymer	BR/IR/SBR	CR	BR/IR/SBR	CR	SBR/BR	IR/BR	BR/IR/SBR
Density [g/cm³] [lb/ft³]	1.12 (69.92)	1.42 (88.6477)	1.12 (69.92)	1.40 (87.3991)	1.24 (77.41067)	1.12 (69.92)	1.13 (70.5436)
Hardness [Shore A]	63 ± 5	62 ± 5	63 ± 5	62 ± 5	68 ± 5	62 ± 5	60 ± 5
Abrasion [mm³]	120	130	120	130	125	60	120
Resilience [%]	47	27	47	27	40	53	45
Profile grooves [inches]	2 x 1/4 x 1/8	2 x 1/4 x 1/8	2 x 3/8 x 5/16 2 x 5/16 x 1/4	2 x 3/8 x 5/16 2 x 5/16 x 1/4	2 x 3/8 x 5/16 2 x 5/16 x 1/4	2 x 3/8 x 5/16 2 x 5/16 x 1/4	2 x 5/16 x 1/4
Color	black	black	black	black	black	black	black
Flammability	—	self-extinguishing ¹⁾	—	self-extinguishing ¹⁾	flame resistant ²⁾	—	—
Electric Resistance	—	anti-static ^{1) 3)}	—	anti-static ^{1) 3)}	anti-static ^{1) 3)}	—	—
Approval for underground use	—	D (LOBA) ⁴⁾ PL (WUG) ⁵⁾ USA (MSHA) ⁶⁾ RUS (GOST) ⁷⁾	—	D (LOBA) ⁴⁾ PL (WUG) ⁵⁾ USA (MSHA) ⁶⁾ RUS (GOST) ⁷⁾	—	—	—
Operating temperature	- 22 °F to + 176 °F - 30 °C to + 80 °C	- 22 °F to + 176 °F - 30 °C to + 80 °C	- 22 °F to + 176 °F - 30 °C to + 80 °C	- 22 °F to + 176 °F - 30 °C to + 80 °C	- 22 °F to + 176 °F - 30 °C to + 80 °C	- 22 °F to + 176 °F - 30 °C to + 80 °C	- 22 °F to + 176 °F - 30 °C to + 80 °C

¹⁾ Meets all safety requirements according to DIN 22100-7 (fire safety, hygiene, electrical); ²⁾ according to EN 20340; ³⁾ also for ATEX-installations

⁴⁾ LOBA-No.: 18.43.21-89-33; ⁵⁾ Polish approval: Dopuszczenie WUG Katowice-no. GM97/03; ⁶⁾ USA: MSHA IC-205/1; ⁷⁾ RUS: GOST PPC 00-17855

REMAGRIP C

For Pulleys Subject to High Stress

Ceramic material is suitable for pulley lagging, because of its specific properties of extremely high wear resistance provided by aluminum oxide (Al₂O₃). It replaces traditional materials because it provides higher profitability by considerably increasing the service life and the efficiency of pulley laggings.

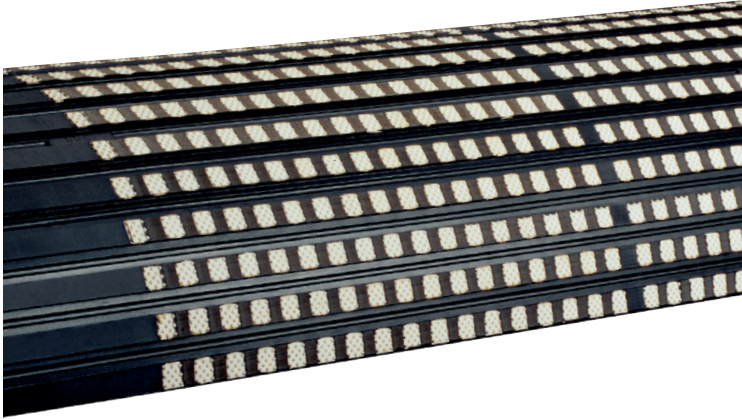

REMAGRIP CK-X – for constant grip

The profiled surface of the ceramic tiles provides optimum grip on pulleys subject to high stress.

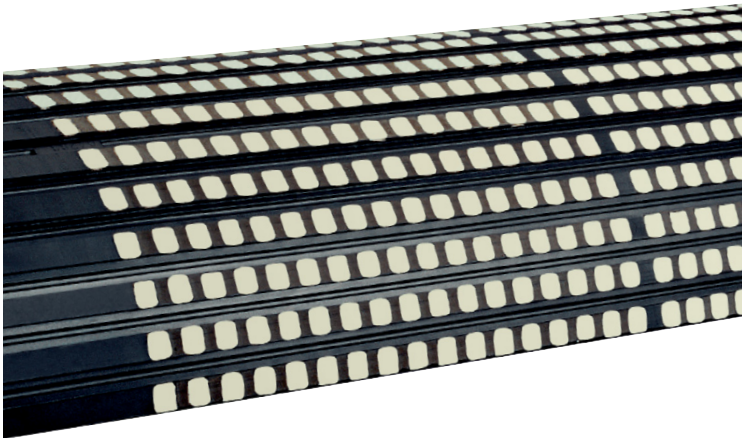

REMAGRIP CP-X – the benchmark for wear resistance

The plain surface of the ceramic tiles is highly efficient, particularly on non-drive pulleys (ranging from tail pulleys to snub pulleys), which are subject to high wear.

Characteristics and advantages of REMAGRIP CK-X and CP-X:

- Provides significantly higher traction than traditional rubber laggings
- High reliability even in wet, clay and muddy operating conditions
- High resistance to wear (service life up to 10 times longer than that of traditional rubber laggings)
- Dynamic resistance optimized by arrangement of ceramic tiles based on FEM calculations
- Unique three-dimensional embedding of the ceramic tiles in the rubber substrate
- High self-cleaning effect due to grooves between the rows of ceramic tiles
- More flexible than traditional rubber/ceramic pulley lagging, therefore even small diameter pulleys can be lagged easily
- Protection of the belt through elastic rubber base (optimum adaptation of the ceramic tiles to the conveyor belt surface)
- Durable adhesion if bonded with the outstanding **REMA TIP TOP** bonding systems

REMAGRIP C

For Pulleys Subject to High Stress

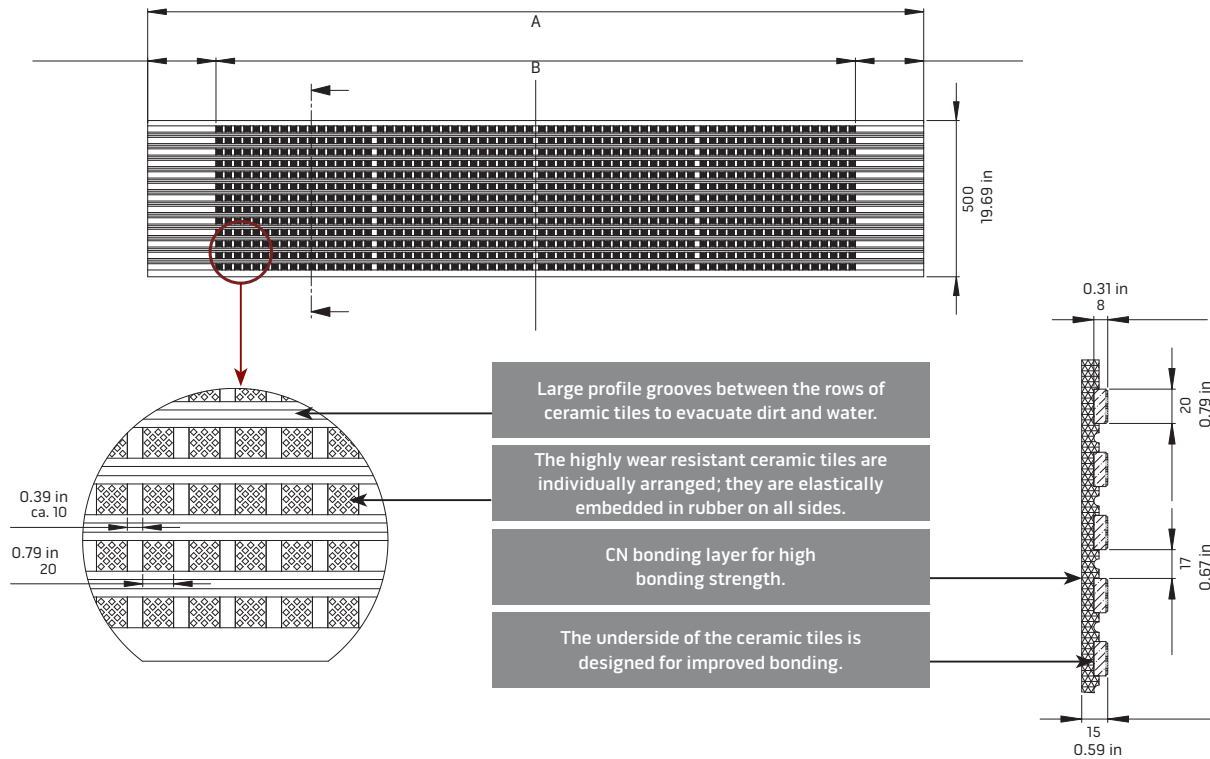

Item name	for belt width [ft]	A total width [ft]	B width ceramics [ft]
CK-X (ceramic tiles with knobs – for drive pulleys)			
REMAGRIP CK-X 40/800	2.62	4.10	2.76
REMAGRIP CK-X 40/900 FS	2.95	4.10	3.02
REMAGRIP CK-X 45/1 000	3.28	4.92	3.61
REMAGRIP CK-X 50/1 200	3.94	5.25	3.94
REMAGRIP CK-X 50/1 400 FS	4.59	5.25	4.76
REMAGRIP CK-X 60/1 500	4.92	6.23	5.28
REMAGRIP CK-X 70/1 600	5.25	6.89	5.64
REMAGRIP CK-X 75/1 800	5.91	7.55	6.17
REMAGRIP CK-X 70/2 000 FS	6.56	6.89	6.76
REMAGRIP CK-X 90/2 000	6.56	8.20	6.76
REMAGRIP CK-X 90/2 400 FS	7.87	8.20	7.94
REMAGRIP CK-X 110/2 400	7.87	9.45	7.94
CK-X V ("V" quality: rubber in self-extinguishing quality, limited oil- and grease-resistant)			
REMAGRIP CK-X 50/1 200 V	3.94	5.25	3.94
REMAGRIP CK-X 70/1 600 V	5.25	6.89	5.64
REMAGRIP CK-X 90/2 000 V	6.56	8.20	6.76
CP-X (ceramic tiles plain – for tail pulleys)			
REMAGRIP CP-X 40/800	2.62	4.10	2.76
REMAGRIP CP-X 45/1 000	3.28	4.92	3.61
REMAGRIP CP-X 50/1 200	3.94	5.25	3.94
REMAGRIP CP-X 60/1 500	4.92	6.23	5.28
REMAGRIP CP-X 70/1 600	5.25	6.89	5.64
REMAGRIP CP-X 75/1 800	5.91	7.55	6.17
REMAGRIP CP-X 90/2 000	6.56	8.20	6.76

Length for all sizes: 500 mm thickness for all sizes: 15 mm (8mm ceramics / 7mm rubber)
 Length for all sizes: 1.64ft thickness for all sizes: 5/8in (5/16in ceramics / 0.28in rubber)
 FS = "Fullsize" - ceramic tiles from edge to edge (fits all pulley widths)

REMALINE 65

Rubber lagging for individual grooving



REMALINE

Fields of application and product advantages:

- Plain pulley lagging to be grooved with **RUBBER CUT System**
- Custom profile design (e.g. herring bone profile, waffle profile, chevron profile)
- Avoidance of material build-up with positive influence on belt tracking
- Reduces slippage between belt and pulley through increased coefficient of friction
- Protects the pulleys from wear and corrosion
- Specifically designed for conveyor belts with fabric plies
- Available in multiple durometers

REMAGRIP 100

For extremely wet operating conditions



REMAGRIP 100/CN

Fields of application and product advantages:

- Lagging of drive pulleys for light fabric belts (up to 330 PIW)
- Difficult operating conditions (extremely wet, ice, clay or other smeary materials)
- High resistance to wear
- Excellent self-cleaning properties
- Improved belt tracking
- HD version for lagging medium-duty fabric belts (up to EP 1 250)

Technical Data:

Property	REMALINE 50	REMALINE 60	REMALINE 70	REMAGRIP 100/CN	REMAGRIP 100 HD/CN
Polymer	NR	BR/IR/SBR	NR/BR	BR/IR	BR/IR
Density [g/cm ³] [lb/ft ³]	1.11 (69.30)	1.13 (70.54)	1.09 (68.05)	1.10 (68.67)	1.40 (87.40)
Hardness [Shore A]	51	60	63	64 ± 5	62 ± 5
Abrasion [mm ³]	160	90	60	50	50
Resilience [%]	70	44	53	51	51
Profile grooves	-	-	-	knobs round (¼ in)	knobs oval (0.28 in)
Color	Orange	Black	Black	black	black
Operating temperature	- 30 °C to + 80 °C - 22 °F to + 176 °F	- 30 °C to + 80 °C - 22 °F to + 176 °F	- 30 °C to + 80 °C - 22 °F to + 176 °F	- 30 °C to + 80 °C - 22 °F to + 176 °F	- 30 °C to + 80 °C - 22 °F to + 176 °F

REMAGRIP 60 - 200 WHITE

For the pharmaceutical and food processing industry



REMAGRIP 60 WHITE FOOD/CN

REMAGRIP 60 WHITE OIL FOOD/CN

REMAGRIP 200 WHITE OIL FOOD/CN

Fields of application and product advantages:

- Pulley lagging for rubber and PVC/PUR conveyor belts
- Evacuation of moisture and dirt
- Reduced slippage between belt and pulley, increased coefficient of friction
- Avoidance of material build-up with positive influence on belt tracking
- Protects the pulleys from wear and corrosion
- Easy cleaning thanks to wide grooves (**REMAGRIP 200**)
- Highly effective evacuation of dirt and water thanks to transverse grooves (**REMAGRIP 200**)

Technical Data:

Property	REMAGRIP 60 WHITE FOOD/CN	REMAGRIP 60 WHITE OIL FOOD/CN	REMAGRIP 200 WHITE OIL FOOD/CN
Polymer	NR/BR	NBR	NBR
Density [g/cm ³] [lb/ft ³]	1.19 (74.29)	1.23 (76.79)	1.23 (76.79)
Hardness [Shore A]	60 ± 5	56 ± 5	56 ± 5
Abrasion [mm ³]	160	160	160
Resilience [%]	57	30	30
Profile grooves [in]	0.71 x 1/4 x 1/8	0.71 x 1/4 x 1/8	5/16 x 3/16
Color	white	white	white
Food contact	yes*	yes*	yes*

*Compliance in accordance with US FDA regulation 21 CFR 177.2600.

*Compliance in accordance with the German BgVV regulation, category 3+4, 167. notice, paragraph XXI.

REMA TIP TOP/North America, Inc.

1500 Industrial Blvd. • Madison, GA 30650 • Phone 800.334.REMA (7362) • 706.752.4000 • Fax 706.752.4015 → www.rematiptop.com